

**SITE LOCATION MAP**  
NOT TO SCALE

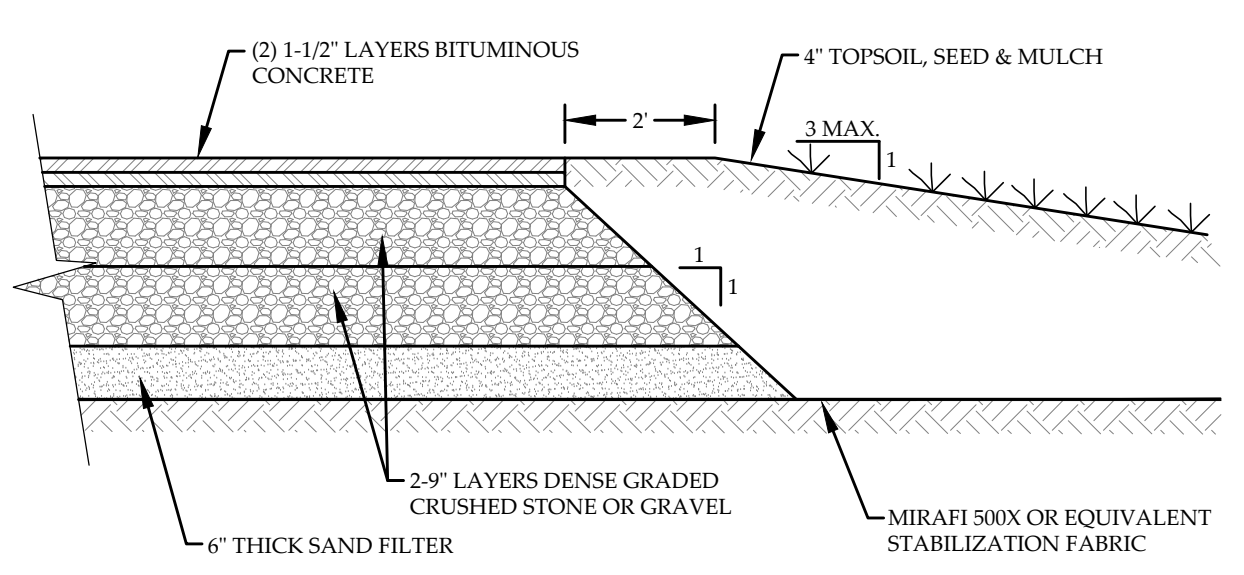

**(2) C.T. TYPICAL PAVEMENT SECTION**  
NOT TO SCALE

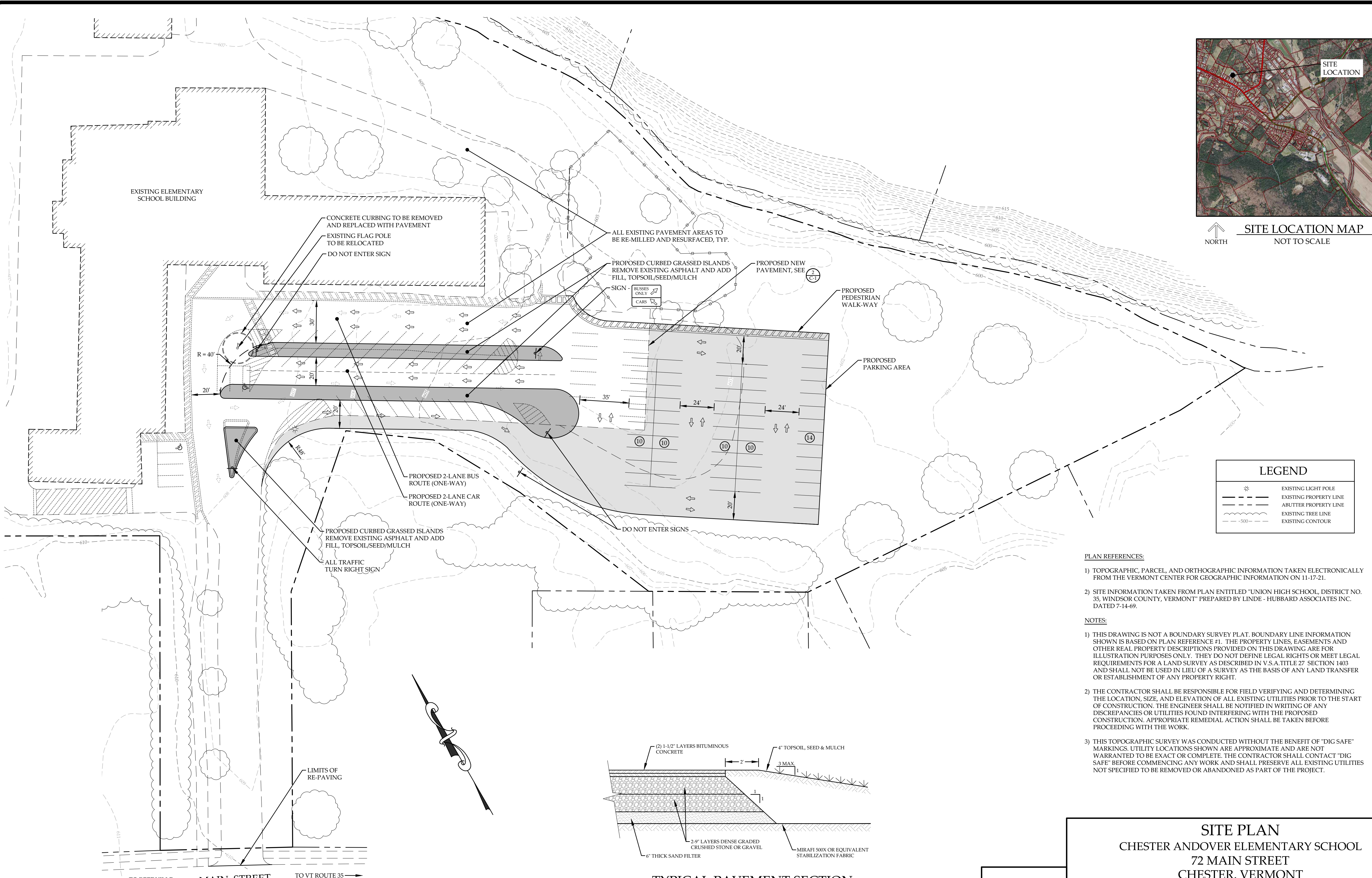
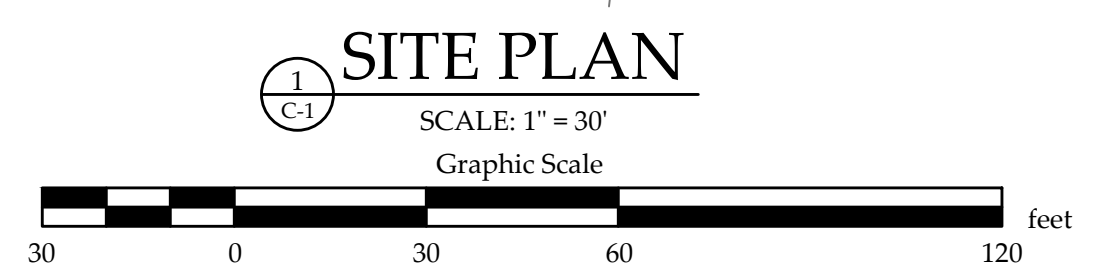

**SITE PLAN**  
CHESTER ANDOVER ELEMENTARY SCHOOL  
72 MAIN STREET  
CHESTER, VERMONT

<p><b>MUMLEY ENGINEERING, INC.</b> 11 MOSS GLENN FALLS ROAD STOWE, VERMONT 05672 WWW.MUMLEYENGINEERING.COM COPYRIGHT © 2021 - MUMLEY ENGINEERING, INC.</p>	PROJECT NO.....21125	HEET NO.
	DRAWN BY.....WEH/REB	C-1
	CHECKED BY.....TRM	
	SCALE.....1" = 30'	
DATE.....11/18/21	1 OF 1 SHEETS	